

# 16-Channel 1080P Cabinet Debugging Monitor

## SG EMO-17316

Product Specification Documents

Ver 1.0



▲ Physical Reference

**深圳市瑞众科技有限公司**  
SHENZHEN RUIZHONG TECHNOLOGY CO., LTD.

# Product Description

---

ShenGong SG EMO series integrates LED display, ultra-thin keyboard, and mouse touchpad, set in a 1U height unit, the use of drawer installation mode, completely solves the space shortage of standard keyboard, monitor, and mouse compared to saving 85% space. High-quality Class A 17.3 "LED (no highlights) display, built-in switcher can directly manage 16 servers; Up to 512 servers can be managed.

## Main features

---

- ★ Support 16 HDMI signal input, a single group of control terminal management of 16 servers, can cascade multiple devices, up to 512 computers.
- ★ 17.3" LED screen, keyboard, mouse and switch integration, single double slide body, only 1U rack space; 17.3 inch LED LCD display, high brightness, high definition, resolution up to 1920x1080@60Hz.
- ★ Support server naming and fuzzy input SN number can quickly locate and select the server security function you need.
- ★ Support multi-user account management and management level, password protection and search PC server name.
- ★ Effectively save room space, when the keyboard/trackpad is not needed, it can be pushed back into the rack, only the thin LED display is retained to facilitate the management to monitor the status of the server, and the guide rail is equipped with self-locking device.
- ★ Support hot swap - Add or remove servers at any time without turning off the power.

- ★ Provide automatic scanning mode, and sustainable monitoring of the user's selected host.
- ★ Drawer type, USB HUB function can be realized through the front USB2.0 interface.
- ★ Easily switch between servers with hotkeys and panel keys.
- ★ Compatible with Dos/Windows series, UnixMac OS 8.6/9/10, SUN Solaris 8/9, Kirin System, UOS (unified operating system, UnionTech OS, Deepin, Puhua OS, Red Flag Linux, and other operating systems.
- ★ The LED display can be expanded to 135 degrees to provide a comfortable viewing Angle.

## Product Appearance

---



▲ Front view



▲ Back view



▲ Interface display

# Product Connection Diagram

---

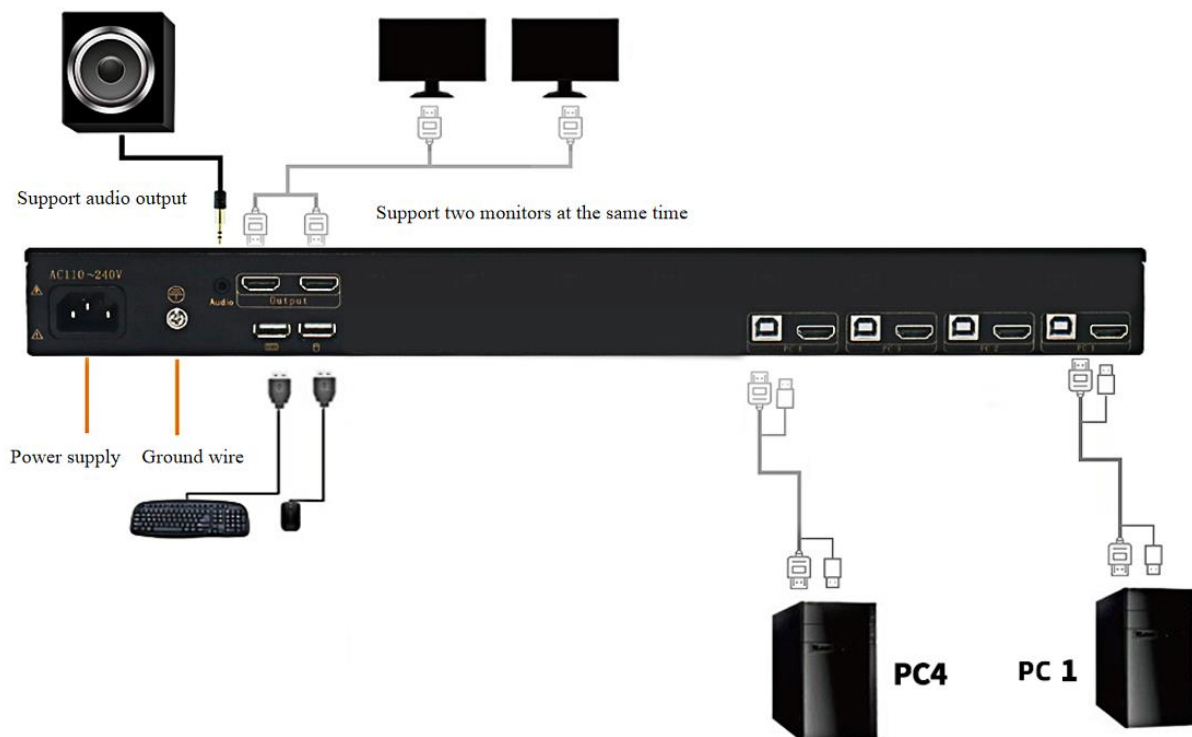

## Technical specifications

---

Model: SG EMO-17316

Accessories: Includes 2 mounting ears, 4 KVM cables (1.8 meters), optional 3-meter and 5-meter cables available

Computer Connection: 16 computers

Maximum Computer Connection: 512 computers

Connection Ports: HDMI interface (3\*USB for keyboard and mouse)

Switching Scan Time :	1-255 seconds (adjustable via OSD)
Applicable Cabinet :	800-1040MM
Switching Method :	Hotkey switching, button switching
LED Display :	Size: 17.3" LED Resolution: 1920*1080@60Hz Brightness: 300 nits Contrast Ratio: 1000:1
LED Display Control :	Multi-language OSD adjustment for optimal performance
Keyboard /Mouse :	104-key mechanical silent keyboard Touchpad
Voltage Input :	A110V-240V 50Hz-60Hz Power Consumption: 35W
Material :	High-strength anti-corrosion steel plate
Exterior Color :	Insulated black paint
Dimensions (L*W*H) :	450mm (depth) * 481mm (width) * 43.8mm (height)
Gross Weight :	17.5KG
Storage Temperature :	-30°C~70°C
Operating Temperature :	-10°C~60°C
Humidity :	0%-80%/RH